

SPECIFICATIONS

Performance	Range	Max. 800m (line of sight)
	Endurance	Max 70min @3m/s
	Speed	Max. 7m/s
Physical	Hull Material	LLDPE
	Total Weight	16.75 kg
	Dimensions (HxWxD)	100cm(L) × 70cm(W) × 25cm(H)
	Waterproof	IP67
	Towing Capacity	Up to 1000kg
Environmental	Working Temperature	-20°C to 40°C
	Storage Temperature	-5°C to 40°C
Battery	Technology	Lithium Ion
	Capacity	680.4Wh
	Charging Temp Range	5°C to 40°C
	Charging Time	4 Hours
Radio	Frequency	2.4GHz

Note : Performance values apply to standard scenarios (flat water, no wind). Varying conditions may affect results.

Technical Specifications Oceanalpha Products

Last updated: 20/06/2025

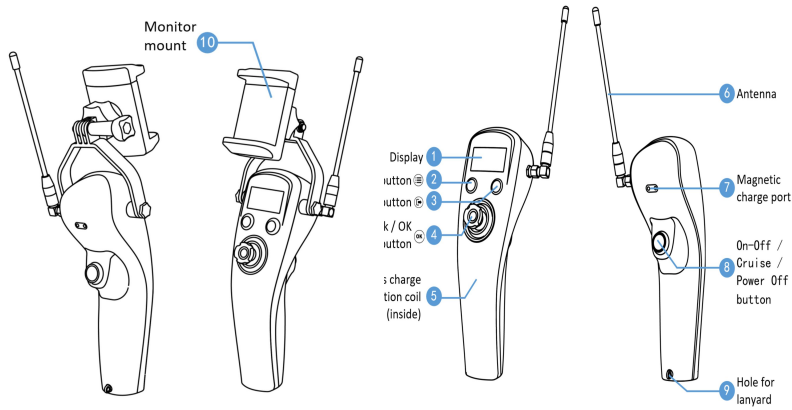

SPECIFICATIONS

Physical	Total Weight	< 300g
	Dimensions (HxWxD)	186.1mm *54.9mm *48.5mm
	Waterproof	IP67
Radio	Frequency	2.4GHz
Battery	Technology	Lithium Ion
	Capacity	5000mAh,18.25Wh
	Nominal Voltage	3.65V
	Weight	73g

Technical Specifications Oceanalpha Products
Last updated: 20/06/2025



SPECIFICATIONS

Environmental	Operating Temperature	-10°C to 40°C
	Storage Temperature	-40°C to 70°C
	Relative Humidity	5% to 95%
Power Supply	Power Output	300W
	DC Voltage	25.2 Vdc
	Output Current	8A
	Input Voltage	110Vac/220Vac, 50-60Hz



SPECIFICATIONS

Physical	Total Weight	
	Dimensions (HxD)	732mm*515.1mm
Environmental	Operating Temperature	-10°C to 40°C
	Storage Temperature	-10°C to 70°C
	Relative Humidity	5% to 95%
Power Supply	Power Output	300W
	DC Voltage	25.2 Vdc
	Output Current	8A
	Input Voltage	110Vac/220Vac, 50-60Hz
Environmental	Operating Temperature	-10°C to 40°C
	Storage Temperature	-40°C to 70°C
	Relative Humidity	5% to 95%
Power Supply	Power Output	300W
	DC Voltage	25.2 Vdc
	Output Current	8A
	Input Voltage	110Vac/220Vac, 50-60Hz

Technical Specifications Oceanalpha Products
Last updated: 20/06/2025